

VersiPod 2 Specifications

Height range, monopod mode:	46.75" to 62.5"
Height range, tripod mode:	43.0" to 58.75"
Closed height:	46.25"
Column diameter:	1.1"
Weight w/MagMount ball head:	1.63 lb
Weight w/ball head:	1.59 lb
Load capacity:	Up to 9 lb,
contingent upon center of gravity	

Product specifications and design subject to change without notice.

Important Information on using your VersiPod 2 MagMount Adapters if equipped

Two Mag Mount adapters-one each high and low strength-are supplied with your MagMount version of the VersiPod 2.

For easier installation, the adapters are packaged separately from the head. If placed on the head prior to installation on your camera, field scope, etc., you will find that the magnetic grip is so strong that it is difficult to remove!

In that case, screw any device with a standard 1/4"-20 tripod mount onto the MagMount, and apply leverage to break the magnetic grip.

The black MagMount adapter is high strength and the silver adapter is low strength.

Precautions

- Insure that all levers, handles, knobs and leg locks are properly tightened, and that all three legs are fully angled opened before use.
- Do not remove and attach any camera or device directly onto the head mount screw located under the ball head of the VersiPod 2's upper tube assembly. **The screw that the ball head attaches to is longer than the depth of a tripod socket of a camera or device, and will cause serious damage if installed directly to it!**
- Do not carry or transport the VersiPod 2 with equipment attached (as example but not limited to: over your shoulder or cradled in your arms).
- Do not Oil or Grease any part of the VersiPod 2.
- Do not use any solvents or thinners to clean your VersiPod 2. Use mild detergent and wipe dry with a soft, lint-free cloth only.
- Do not store or expose your tripod to excessive heat or cold or use close to any flame or fire.
- Do not exceed the load limit for this product.

Sunpak VersiPod II Limited Lifetime Warranty

This Sunpak product has been carefully manufactured, accurately adjusted, inspected and thoroughly tested before shipment to assure you of the highest quality.

Should this Sunpak product require service, we will repair or replace, at our option, any part or the product itself, which our examination shows to be defective in material or workmanship. This warranty does not apply to wear and tear associated with the normal use of the product. This warranty is non-transferable.

Repairs will be made to the product at no charge, under the terms of the warranty as stated above, only when accompanied by a dated and itemized bill of sale and the stated handling charge.

Be certain to follow all setup and/or operating instructions with this product. This warranty is not valid if the product has been misused or damaged in any way that is beyond our control or through normal wear and tear associated with use. This warranty applies only to the product and we are not responsible in any way for losses, damages or any inconvenience caused by equipment failure.

Some states do not allow the exclusion or limitation of consequential damages, so the above limitation or exclusion may not apply to you. This warranty gives you specific legal rights and you may have other rights which may vary from state to state.

Should service be required, the product should be carefully packed (in the original packaging if possible) and sent, prepaid and insured, along with a check or money order for \$9.95 (shipping and handling), to the address listed below. A note briefly describing the nature of the defect should also be enclosed to expedite handling.

Proof of purchase and payment for shipping and handling must be included for warranty repairs.

OWNER'S RECORD

Please complete this section and retain with your original bill of sale for your records.

Model Number: Sunpak VersiPod 2

Purchase Date: _____

Dealer's Name: _____

Address: _____

City: _____

State: _____ Zip Code: _____

ToCAD America Inc.
Sunpak Tripod Division
53 Green Pond Road
Rockaway, NJ 07866
973-627-9600
www.tocad.com

SUNPAK® VersiPod 2

Operating Instructions

Congratulations on the purchase of your new Sunpak VersiPod 2 Monopod/Tripod. Your VersiPod 2 has been designed to be a sturdy, rugged, and dependable product and will provide you with many years of reliable service.

Please spend a few moments reviewing these instructions, so that you can take full advantage of your Sunpak VersiPod 2's features and capabilities.



VersiPod 2 w/MagMount Ball Head, Cat. no. VPOD2-MAG-B
VersiPod 2 with Ball Head, Cat. no. VPOD2-BR

Determining MagMount Suitability of Any Camera or Optical Device

The process to determine whether your camera, spotting scope, or other optical device will be well suited to the MagMount takes the following four steps:

1. Weigh your device (MagMount will support devices from 2 to 9 pounds, depending on where the center of gravity is for the device)
2. Find the horizontal balance point
3. Measure the offset distance
4. Find your device weight and offset on the chart

These steps are easy to do and take less than 5 minutes to complete.

1. Weigh Your Device

It's important to get the actual weight of your spotting scope or camera/lens combination. For cameras with interchangeable lenses, use your heaviest lens for this step. For accurate results, use a postal scale or kitchen scale. Remember this measurement for the last step.

2. Horizontal Balance Point

For this step you need a desk ruler and a pencil (or similar item). Place the pencil on a level surface and then place the ruler across the pencil so it is perpendicular to the pencil. Next, place your device on the ruler with the lens parallel to the ruler. Then hold the device horizontally, keeping it safe, and move the device (or pencil) until you find the point where the device will nearly balance on the pencil. (You don't need to be exact.) This is the balance point of your device. Remember this point for the next step.

3. Offset Distance

On your device find the threaded hole for mounting to a tripod. Measure the distance from this hole to the balance point of your device, which was found in the previous step. This is the offset distance of your device. Remember this measurement for the next step.

4. Device Weight and Offset

This is the last step. Use our Suitability Chart, below, to find the horizontal line for the weight of your device, and the vertical line for the offset distance of your device. Now find the intersection of these two lines on the chart. If this intersection is below the curve shown on the chart, then the MagMount will accommodate your device nicely. If the intersection is above the curve, then we recommend a larger ball head for your device.

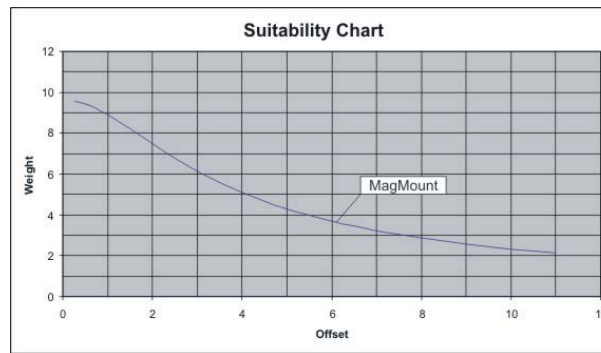

(Based on device CG of approximately 2.5" above the plane of the mounting base.)

For additional information please visit www.trek-tech.com.



Extending the Column

To extend the column, rotate the collar counter clockwise and gently pull the upper section upward to the desired height. Do not extend beyond the maximum extension mark. To lock, rotate the collar clockwise.

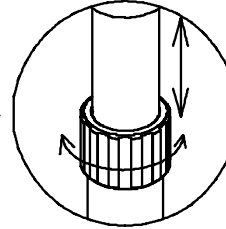

Extending Legs in Tripod Mode

To extend the legs for tripod mode, unwrap the hook and loop strap and extend all three legs to their maximum extension. In monopod mode, close all three legs and tightly wrap the hook and loop strap to secure.

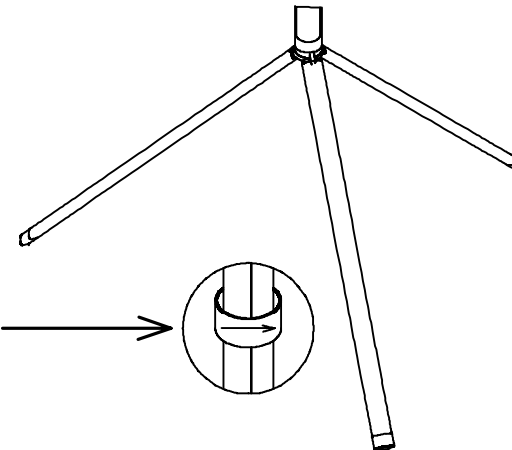

Mounting MagMount Adapters to Devices

Small lightweight devices weighing up to 4 pounds use the silver, low strength adapter. For devices that weigh 4 to 9 pounds use the black high strength adapter. For extra security always use the safety clip over the MagMount adapter and MagMount head.

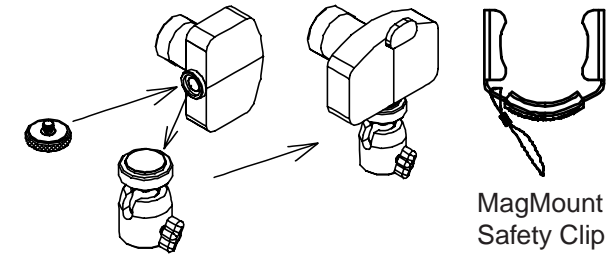

MagMount Ball Head Operation

The MagMount ball head can be adjusted as desired for optimum use. In addition, the head can be moved to the vertical position when using a camera.



Ball Head Operation

The ball head comes packed with a protective cap that needs to be removed before a device can be mounted. The ball head can be moved as desired for optimum use and to the vertical position when using a camera.

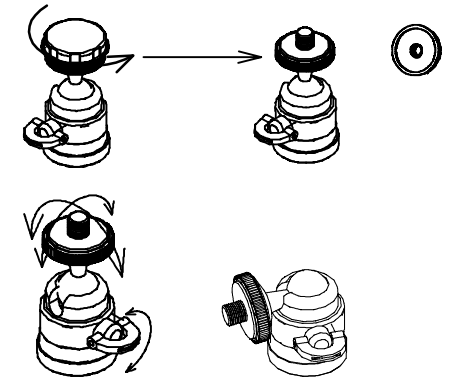

Removal of Hand Strap

First remove the ball head and mounting plate by turning counter clockwise. Remove strap and reinstall the mounting plate and ball head and securely tighten.

Do Not Use Without Ball Head Attached!